

This comment is regarding 2 matters raised at the inquiry.

1 The effect of the substation on the openness of the Green Belt.

the substation covers an area of circa 15 acres, the surrounding field also has 3 pylons from the north YN008,009,0010 and then a further 6 pylons XC415,414,416,SP001,002,003.all the pylons are circa 50 m high with a tolerance of 6m if required.In addition there is a large area of planting on the north east side of the substation and some bunding along the A19 boundary.NG stance is that this does not effect the openness of the green belt- this is factually incorrect and no amount of planting will disguise the industrial nature of the proposed facility.If the subsation was located on the west side of the main York to Edinburgh Railway line then it would much less visible from Shipton, Skelton and the A19.The railway line is electrified so the skyline is already tarnished by this overhead infratrstructure and therefore the overall effect would be diminished.

2 Do overhead lines attract development

NG stance is that they don't which is not quite correct.In my experience

Renewable Developers pin point a pylon then approach NG to see if there is capacity in the overhead line and if there is, consent to connect is applied for,if this is forth coming then the developer builds their own substation and renewable enterprise be it solar or battery storage.So in this type of development pylon lines do attract development.

RAILWAY  
BRIDGE



SIDING  
CORNER





NATIONAL GRID (YORKSHIRE GREEN ENERGY ENABLEMENT PROJECT) ORDER  
WORKS PLAN  
REGULATION 5(2)(D)  
SECTION B, SHEET 2 OF 5

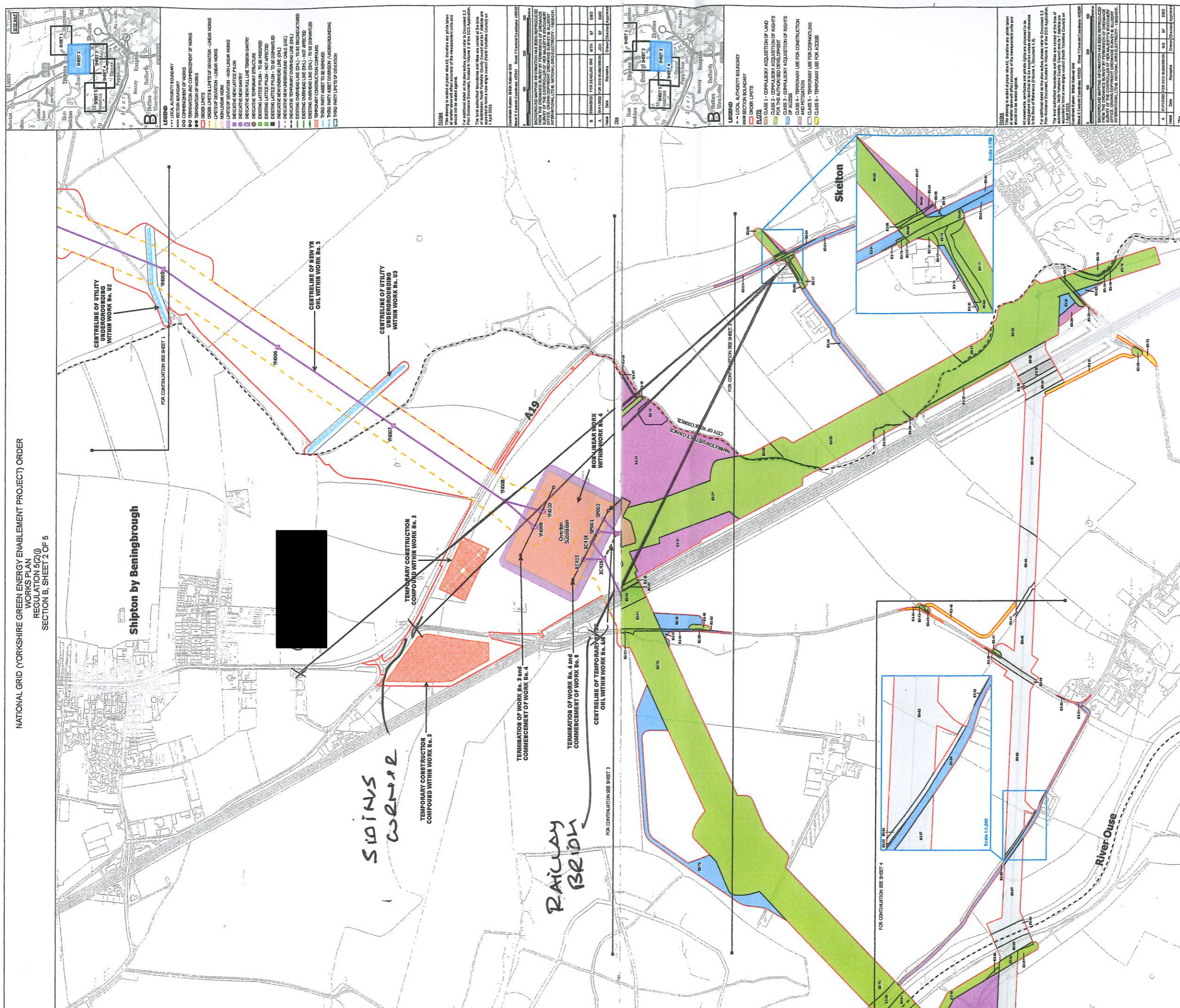

LEGEND		
[Symbol]	LOCAL AUTHORITY BOUNDARY	
[Symbol]	COMPLETION AND COMMENCEMENT OF WORKS	
[Symbol]	TERMINATION OF WORKS	
[Symbol]	WORKS PLAN	
[Symbol]	CLASS 1 - COMPULSORY ACQUISITION OF LAND	
[Symbol]	CLASS 2 - COMPULSORY ACQUISITION OF RIGHTS	
[Symbol]	CLASS 3 - TEMPORARY USE FOR CONSTRUCTION	
[Symbol]	CLASS 4 - TEMPORARY USE FOR OPERATING	
[Symbol]	CLASS 5 - TEMPORARY USE FOR ACCESS	

Item	Date	Drawn	Checked	Approved
1				
2				
3				
4				

CONDITIONS: 1. THE DRAWING IS A PRELIMINARY DESIGN. 2. THE DRAWING IS NOT TO BE REPRODUCED WITHOUT THE WRITTEN PERMISSION OF NATIONAL GRID ELECTRICITY TRANSMISSION Plc.

NATIONAL GRID  
YORKSHIRE GREEN ENERGY  
ENABLEMENT PROJECT ORDER  
WORKS PLAN  
REGULATION 5(2)(D)  
SECTION B, SHEET 2 OF 5  
nationalgrid





